

with rack-and-pinion drive module 3 (helical)
and double linear guide (AZSH)

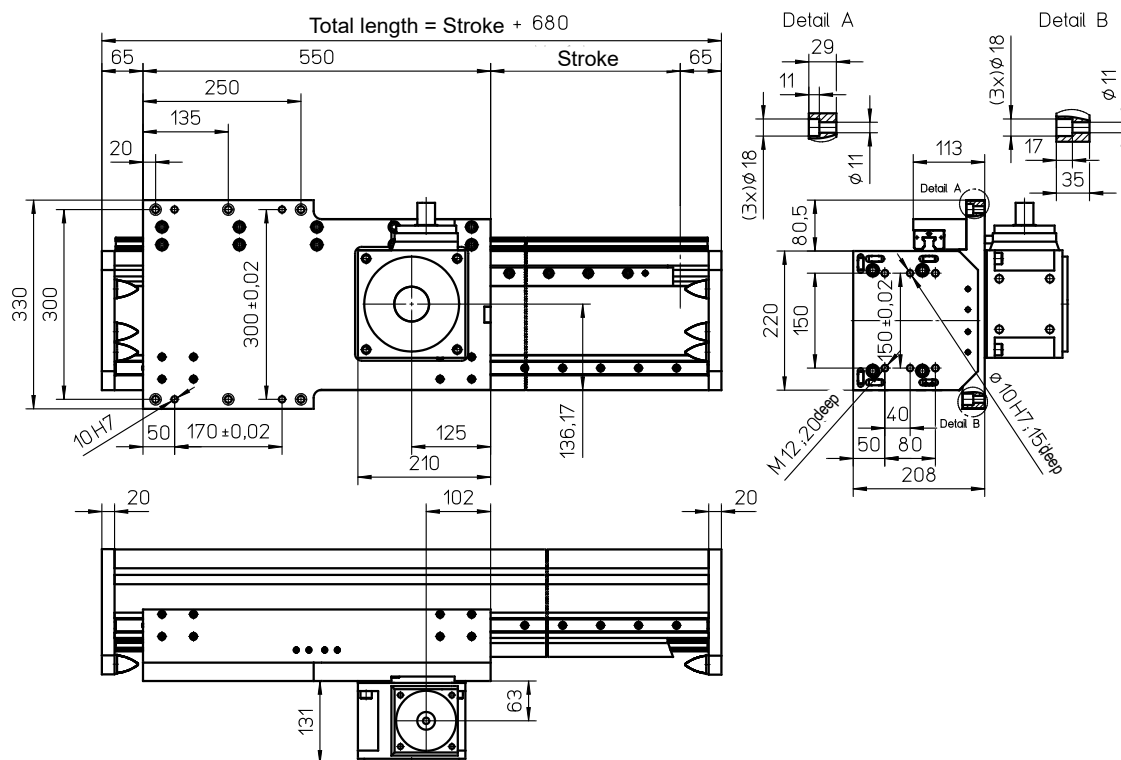

Weights

	AZSH
Basic length without stroke:	53.90 kg*
100 mm stroke:	4.80 kg
Carriage 550 mm:	21.60 kg
Gears D90 / D115:	10.35 / 16.65 kg

Max. total length: 8020 mm
(longer on request)

Forces and moments

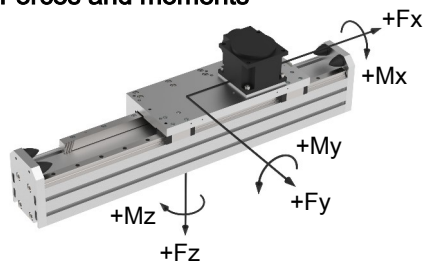

	AZSH-D90	AZSH-D115
Forces	Dynamic [N]	
F_x	3000-4000 **	5000-7500 **
F_y	20000	
F_z	20000	
Moments	Dynamic [Nm]	
M_x	4000	
M_y	8000	
M_z	8000	

Technical Data

	AZSH
Max. speed:	4.50 m/s (D90) / 4.00 m/s (D115)
Max. acceleration:	20 m/s ²
Repeat accuracy:	± 0.05 mm
Idle torque at drive pinion:	7.20 Nm
Rack and pinion:	Module 3 helical
Drive pinion:	Module 3, 20 teeth
Stroke per revolution:	200 mm
Servo-high-performance-gear:	DynaGear D90 / D115
Ratios:	5 / 10 / 15

	D90	D115
Load F_x	Dynamic [N]	
$i = 5:1$	4000	7500
$i = 10:1$		
$i = 15:1$	3000	5000

Preferred gear: D115
Efficiency of gears: > 96 %

Variants for gear mounting see page G29.

* inclusive standard gear

** depending on gear ratio (see table to right)