

with ball screw (KGT) and double linear guide (SSS)

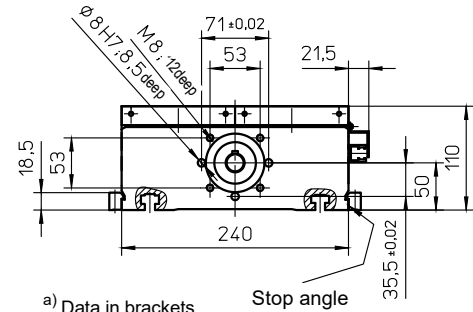
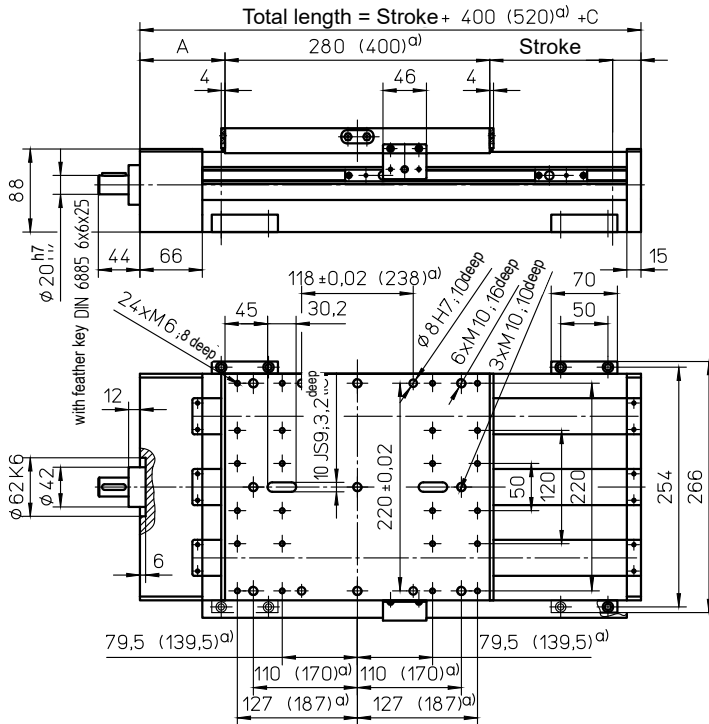

a) Data in brackets refer to long carriage

Mounting elements see page D16

Quantity SA	Version			Version		
	A	B	C	A	B	C
0	90	30	-	90	30	-
2	90	30	-	90	30	-
4	130	70	80	130	70	80

"0 SA" applies for long carriage

## Weights

	SSS
Basic length without stroke:	24.20 kg
100 mm stroke:	3.25 kg
Entire carriage 280 mm:	10.20 kg
Entire carriage 400 mm:	14.60 kg
Max. total length:	5600 mm

## Technical Data

	SSS
Max. total speed:	3.00 m/s
Max. acceleration:	20 m/s <sup>2</sup>
Repeat accuracy:	± 0.03 mm (KGT)
Idle torque:	2.80 Nm

## Forces and moments

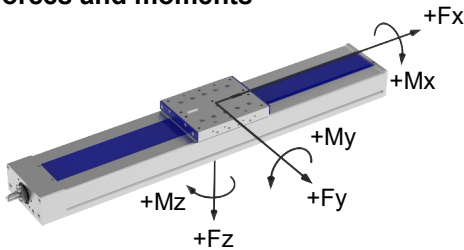

	SSS
<b>Forces</b>	Dynamic [N]
<b>F<sub>x</sub></b>	12000 *
<b>F<sub>y</sub></b>	6000
<b>F<sub>z</sub></b>	12000
<b>-F<sub>z</sub></b>	8000
<b>Moments</b>	Dynamic [Nm]
<b>M<sub>x</sub></b>	4500
<b>M<sub>y</sub></b>	6000 (8500)
<b>M<sub>z</sub></b>	4500 (6400)

Data in brackets refer to long carriage (400)

\* at KGT3240 and 3260: 8000 N

## Drive element

	KGT
Max. rotation speed:	3000 min <sup>-1</sup>
Diameter:	32 mm
Pitch:	5 / 10 / 20 / 40 / 60 mm
Moment of inertia:	6.39 · 10 <sup>-4</sup> kgm <sup>2</sup> /m

## Spindle support (SA)

